

Basement Floor Plan
Floor Area- 13250 Sft

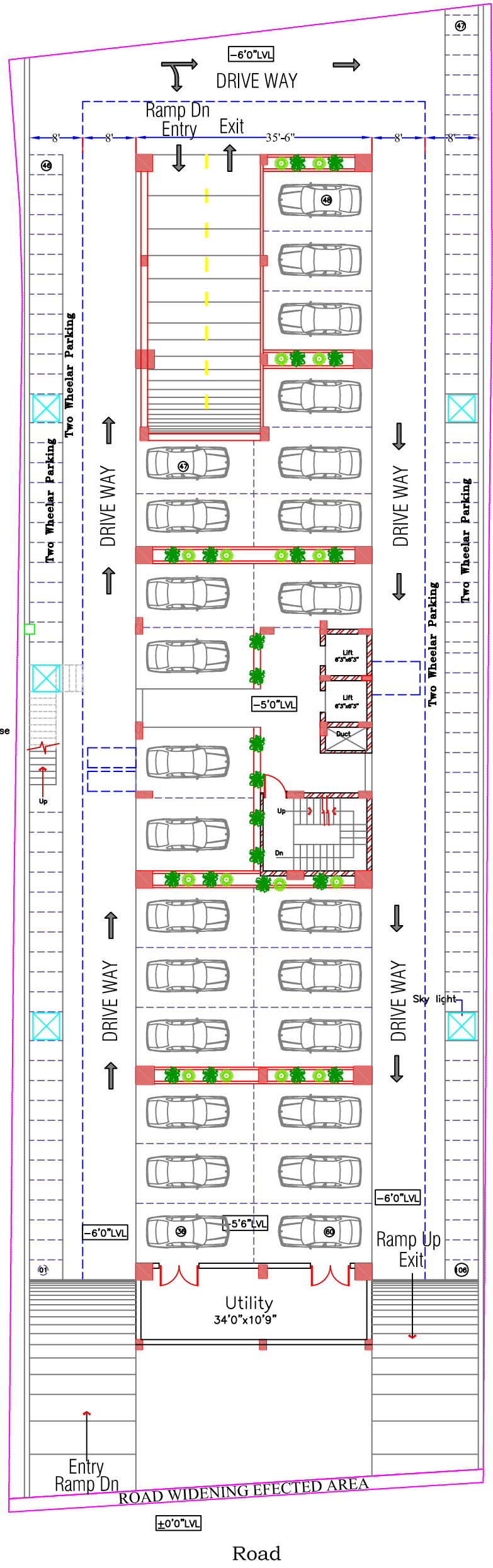

Stilt Floor Plan
Floor Area- 12845 Sft

Project :
Proposed Comercial Complex for Reliance Constructions
at Banjar Hills, Hyderabad

UNUS Architects and Interior Designers Flat No-401, 10-3-32/A, Windsor Castle, Nehru Nagar, East Marredpally, Secunderabad - 500 026. Ph.No - 64539395 Mobile - 9246159395 email: unusdesign@yahoo.co.in	Drawing Title		Sheet No.:
	Floor Plans		DW-TP-P101
	Scale : Not To Scale	Date : 2/11/2006	
Drawing File : d/dra/rel/plan	Drawn By : Sandhya	Checked By : praveen	